



City of Westminster

# Licensing Sub-Committee Report

Item No:	
Date:	22 September 2016
Licensing Ref No:	16/07553/LIPV - Premises Licence Variation
Title of Report:	Tape Basement 17 Hanover Square London W1S 1HU
Report of:	Director of Public Protection and Licensing
Wards involved:	West End
Policy context:	City of Westminster Statement of Licensing Policy
Financial summary:	None
Report Author:	Ms Claire Hayes Senior Licensing Practitioner
Contact details	Telephone: 020 7641 7816 Email: <a href="mailto:chayes@westminster.gov.uk">chayes@westminster.gov.uk</a>

# 1. Application

1-A Applicant and premises			
<b>Application Type:</b>	Variation of a Premises Licence, Licensing Act 2003		
<b>Application received date:</b>	19 July 2016		
<b>Applicant:</b>	Hanover Bars Limited		
<b>Premises:</b>	Tape		
<b>Premises address:</b>	Basement 17 Hanover Square London W1S 1HU	<b>Ward:</b>	West End
		<b>Cumulative Impact Area:</b>	None
<b>Premises description:</b>	The premises operate as a nightclub and members club		
<b>Variation description:</b>	The variation is to seek approval of the proposed alterations to relocate a bar, add new toilets, reconfigure a seating area and relocate the DJ and dance podium		
<b>Premises licence history:</b>	The premises have been licensed since at least 2005		
<b>Applicant submissions:</b>	No additional submissions have been received		

1-B Current and proposed licensable activities, areas and hours						
<b>Regulated Entertainment</b>						
<b>Exhibition of films</b>						
	<b>Current Hours</b>		<b>Proposed Hours</b>		<b>Licensable Area</b>	
	<b>Start:</b>	<b>End:</b>	<b>Start:</b>	<b>End:</b>	<b>Current:</b>	<b>Proposed:</b>
<b>Monday</b>	09.00	03.30	No change		Basement	No change
<b>Tuesday</b>	09.00	03.30				
<b>Wednesday</b>	09.00	03.30				
<b>Thursday</b>	09.00	03.30				
<b>Friday</b>	09.00	03.30				
<b>Saturday</b>	09.00	03.30				
<b>Sunday</b>	09.00	02.30				
<b>Seasonal Variations/ Non-standard timings:</b>	<b>Current:</b>				<b>Proposed:</b>	
	On New Year's Eve the premises can remain open for the purpose of providing regulated entertainment from the time when the provision of regulated entertainment must otherwise cease on New Year's Eve to the time when regulated entertainment can commence on				No change	

	New Year's Day (or until midnight on New Year's Eve where no regulated entertainment takes place on New Year's Day).	
--	--	--

<b>Performance of live music, Performance of Dance &amp; Anything similar to Live Music, Recorded Music or Performance of Dance</b>						
	<b>Current Hours</b>		<b>Proposed Hours</b>		<b>Licensable Area</b>	
	<b>Start:</b>	<b>End:</b>	<b>Start:</b>	<b>End:</b>	<b>Current:</b>	<b>Proposed:</b>
<b>Monday</b>	09.00	03.30	No change		Basement	No change
<b>Tuesday</b>	09.00	03.30				
<b>Wednesday</b>	09.00	03.30				
<b>Thursday</b>	09.00	03.30				
<b>Friday</b>	09.00	03.30				
<b>Saturday</b>	09.00	03.30				
<b>Sunday</b>	09.00	01.00				
<b>Seasonal variations/ Non-standard timings:</b>	<b>Current:</b> On New Year's Eve the premises can remain open for the purpose of providing regulated entertainment from the time when the provision of regulated entertainment must otherwise cease on New Year's Eve to the time when regulated entertainment can commence on New Year's Day (or until midnight on New Year's Eve where no regulated entertainment takes place on New Year's Day).				<b>Proposed:</b> No change	

<b>Playing of Recorded Music &amp; Private Entertainment consisting of dancing, music or other entertainment of a like kind for consideration and with a view to profit</b>						
	<b>Current Hours</b>		<b>Proposed Hours</b>		<b>Licensable Area</b>	
	<b>Start:</b>	<b>End:</b>	<b>Start:</b>	<b>End:</b>	<b>Current:</b>	<b>Proposed:</b>
<b>Monday</b>	Unrestricted		No change		Basement	No change
<b>Tuesday</b>						
<b>Wednesday</b>						
<b>Thursday</b>						
<b>Friday</b>						
<b>Saturday</b>						
<b>Sunday</b>						
<b>Seasonal variations/ Non-standard timings:</b>	<b>Current:</b> On New Year's Eve the premises can remain open for the purpose of providing regulated entertainment from the time when				<b>Proposed:</b> No change	

	the provision of regulated entertainment must otherwise cease on New Year's Eve to the time when regulated entertainment can commence on New Year's Day (or until midnight on New Year's Eve where no regulated entertainment takes place on New Year's Day).	
--	---	--

Late night refreshment		No Change				
Indoors, outdoors or both		Current : Both		Proposed: No change		
	Current Hours		Proposed Hours		Licensable Area	
	Start:	End:	Start:	End:	Current:	Proposed:
Monday	23.00	03.00	No change		Basement	No change
Tuesday	23.00	03.00				
Wednesday	23.00	03.00				
Thursday	23.00	03.00				
Friday	23.00	03.00				
Saturday	23.00	03.00				
Sunday	23.00	02.00				
<b>Seasonal variations/ Non-standard timings:</b>	<b>Current:</b> The terminal hour for late night refreshment on New Year's Eve is extended to 05:00 on New Year's Day.				<b>Proposed:</b> No change	

Sale by Retail of Alcohol		No Change				
On or off sales		Current :		Proposed:		
		On & Off		No change		
	Current Hours		Proposed Hours		Licensable Area	
	Start:	End:	Start:	End:	Current:	Proposed:
Monday	09.00	03.00	No Change		Basement	No change
Tuesday	09.00	03.00				
Wednesday	09.00	03.00				
Thursday	09.00	03.00				
Friday	09.00	03.00				
Saturday	09.00	03.00				
Sunday	12.00	02.00				
<b>Seasonal variations/ Non-standard timings:</b>	<b>Current:</b> The Sale by Retail of Alcohol is permitted On New Year's Eve from the end of permitted hours on New Year's Eve to the start of permitted hours on the following day (or, if there are no permitted				<b>Proposed:</b> No change	

	hours on the following day, 00.00 midnight on 31st December).	
--	---	--

Hours premises are open to the public						
	Current Hours		Proposed Hours		Premises Area	
	Start:	End:	Start:	End:	Current:	Proposed:
Monday	09.00	03.30	No Change		Basement	No change
Tuesday	09.00	03.30				
Wednesday	09.00	03.30				
Thursday	09.00	03.30				
Friday	09.00	03.30				
Saturday	09.00	03.30				
Sunday	09.00	02.30				
<b>Seasonal variations/ Non-standard timings:</b>	<b>Current:</b> N/a				<b>Proposed:</b> N/a	

<b>1-C Layout alteration</b>
The alterations comprise of the replacement of an existing bar with seating and relocation of bar. Reconfiguration of seating areas in main club and little tape and relocation of DJ and dance podium. Addition of new toilets.

## 2. Representations

<b>2-A Responsible Authorities</b>	
<b>Responsible Authority:</b>	Environmental Health - Withdrawn
<b>Representative:</b>	Ian Watson
<b>Received:</b>	16.08.2016
Representation is made to the application on Public Safety. The plan provided indicates that the premises have been split into two separate clubs and the means of escape and capacities need to be assessed.	
<u>Update:</u>	
After discussions a condition relating to capacity was agreed by the applicants the representation was withdrawn. Please see <b>Appendix 4</b>	

<b>2-A Interested Parties</b>			
<b>Name:</b>		Robert Reilly	
<b>Address and/or Residents Association:</b>		Harbottle & Lewis LLP 14 Hanover Square London W1S 1HP	
<b>Status:</b>	Valid	<b>In support or opposed:</b>	Opposed
<b>Received:</b>	01 August 2016		
<p>We occupy 14 Hanover Square. We have suffered constant nuisance involving for example the driving of vehicles on the pavement outside our building over the last year or more as a consequence of works to refurbish buildings in Hanover Square to the west of our building and in Tenterden Street.</p> <p>As it seems likely that further work will follow from the variation of the premises licence referred to above we would ask you please to make it a condition that all deliveries and vehicle movements in relation to this are to Dering Street. The area outside 14 Hanover Square is immediately contiguous to the access to the major Crossrail development site in Hanover Square and on many occasions congestion in this space outside 14 Hanover Square has led to dangerous situations in the adjoining highway system in Hanover Square and Harewood Place as well as vehicles mounting and driving on the pavement outside our office. Whilst Westminster City Council has taken steps to address that by installing metal bollards we still see instances of vehicles mounting the pavement at the point of which the metal bollards run out by 16 Hanover Square.</p>			
<b>Name:</b>		Antony Adel	
<b>Address and/or Residents Association:</b>		20-22 Maddox Street London W1S 1PN	
<b>Status:</b>	Valid	<b>In support or opposed:</b>	Support
<b>Received:</b>	16 August 2016		
<p>Great venue that my friends spend a lot of time with me at; amazing time and always awesome shows with very friendly staff.</p>			

### **3. Policy & Guidance**

The following policies within the City Of Westminster Statement of Licensing Policy apply:	
Policy PB1 applies:	Applications will only be granted if it can be demonstrated that the proposal meets the relevant criteria in Policies CD1, PS1, PN1 and CH1.

## 4. Appendices

<b>Appendix 1</b>	Premises plans
<b>Appendix 2</b>	Applicant supporting documents
<b>Appendix 3</b>	Premises history
<b>Appendix 4</b>	Proposed conditions
<b>Appendix 5</b>	Residential map and list of premises in the vicinity

<b>Report author:</b>	Ms Claire Hayes Senior Licensing Practitioner
<b>Contact:</b>	Telephone: 020 7641 7816 Email: chayes@westminster.gov.uk

**If you have any queries about this report or wish to inspect one of the background papers please contact the report author.**

### **Background Documents – Local Government (Access to Information) Act 1972**

<b>1</b>	Licensing Act 2003	N/A
<b>2</b>	City of Westminster Statement of Licensing Policy	07 January 2016
<b>3</b>	Amended Guidance issued under section 182 of the Licensing Act 2003	March 2015
<b>4</b>	Application form	19 July 2016
<b>5</b>	Representation from Robert Reilly	01 August 2016
<b>6</b>	Representation from Environmental Health	16 August 2016
<b>7</b>	Representation in support from Antony Adel	16 August 2016
<b>8</b>	Environmental Health agree conditions & withdraw representation	01 September 2016

(14)

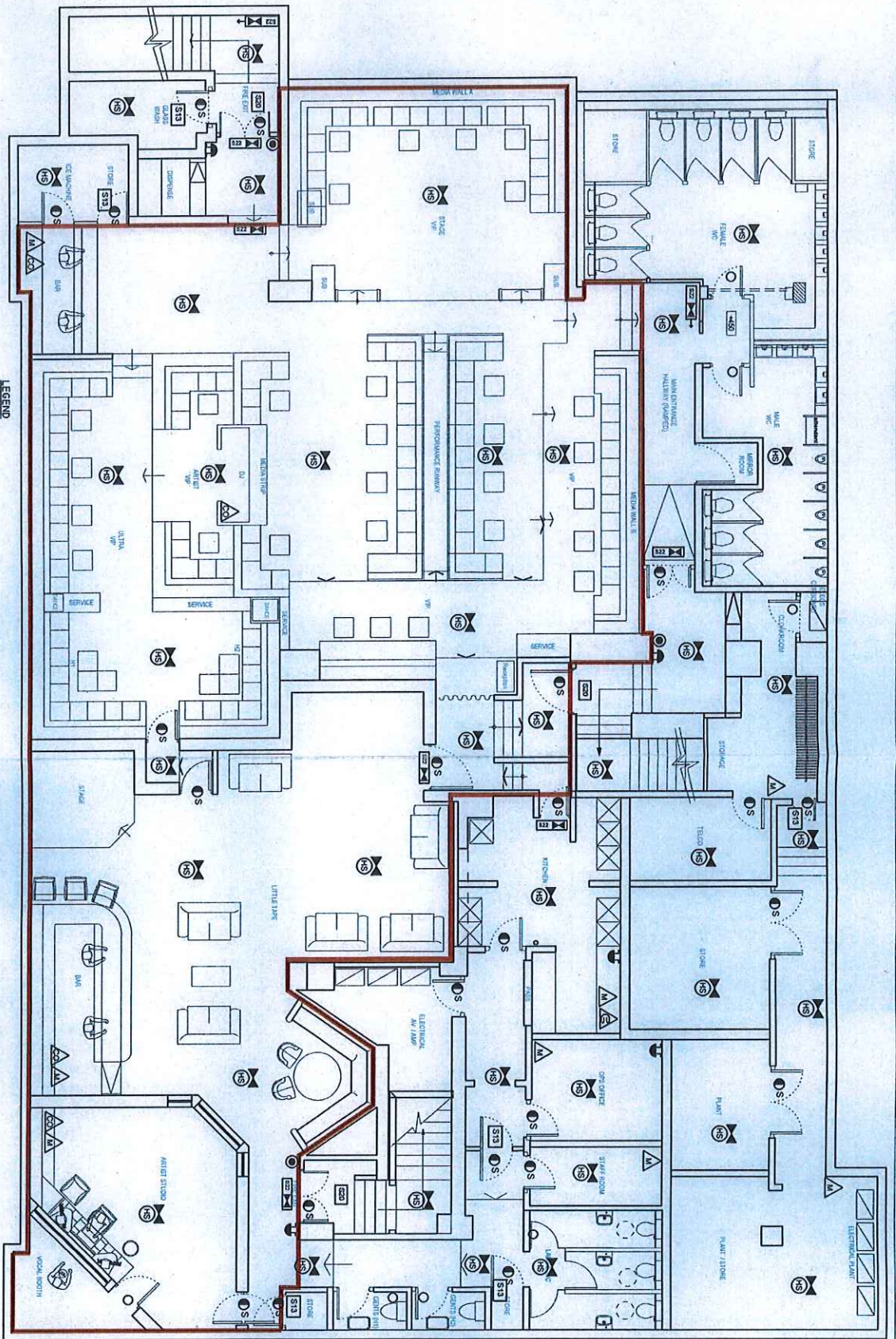

AREA WHERE LICENSABLE ACTIVITIES WILL TAKE PLACE

**NOTE**  
CONSUMPTION OF ALCOHOL AND LICENSABLE ACTIVITIES TAKE PLACE ANYWHERE WITHIN THE PREMISES.  
THE POSITION OF ANY LOOSE FURNITURE IS SHOWN FOR DIAGRAMMATIC PURPOSES ONLY.  
THE LOCATION OF FIRE EQUIPMENT IS SHOWN ON THE DATE HEREOF BUT MAY BE MOVED WITH THE CONSENT OF THE FIRE OFFICER.

- LEGEND**
- FIRE SIGNAGE (EXACT LOCATION TO BE AGREED ON SITE)**
- S22 ILLUMINATED FIRE EXIT SIGN
  - S22 ILLUMINATED FIRE EXIT SIGN (DIRECTIONAL)
  - S14 FIRE DOOR KEEP LOCKED
  - S13 FIRE DOOR KEEP CLOSED
  - S13 FIRE DOOR KEEP LOCKED
  - S13 FIRE DOOR OPEN/DIGITAL CONTROL
  - S20 FIRE ESCAPE KEEP CLEAR
- DOOR TYPE KEY**
- FD00S
  - FD00S
  - FD00
  - FD00
  - FD00
  - FD00
- AREA COVERED WITH A SYSTEM OF ESCAPE LIGHTING THAT WILL ILLUMINATE THE AREA UPON FAILURE OF THE NORMAL LIGHTING POWER SUPPLY TO A SURFICIENT STANDARD TO ENABLE PERSONS TO LEAVE THE AREA SAFELY TO THE LEADERSHIP TO THE BRITISH STANDARD CURRENT AT THE TIME OF ITS INSTALLATION AND A CERTIFICATE TO THIS EFFECT KEPT WITH THE FIRE CERTIFICATE.**
- FIRE SAFETY EQUIPMENT (EXACT LOCATION TO BE AGREED ON SITE)**
- A FIRE EXTINGUISHER - DRY POWDER
  - A FIRE EXTINGUISHER - CARBON DIOXIDE
  - A FIRE EXTINGUISHER - WATER
  - A FIRE EXTINGUISHER - MULTI PURPOSE
  - AB FIRE BLANKET
  - AS AUTOMATIC SMOKE DETECTOR
  - AH AUTOMATIC HEAT DETECTOR
  - AS COMBINED AUTOMATIC HEAT/SMOKE DETECTOR
  - AS FIRE ALARM CALL POINT
  - AS AUDIBLE WARNING DEVICE

Basement Plan Scale 1:50

**TIBBATTS ABEL**  
Fire Safety Engineers  
100, 102, 104, 106, 108, 110, 112, 114, 116, 118, 120, 122, 124, 126, 128, 130, 132, 134, 136, 138, 140, 142, 144, 146, 148, 150, 152, 154, 156, 158, 160, 162, 164, 166, 168, 170, 172, 174, 176, 178, 180, 182, 184, 186, 188, 190, 192, 194, 196, 198, 200, 202, 204, 206, 208, 210, 212, 214, 216, 218, 220, 222, 224, 226, 228, 230, 232, 234, 236, 238, 240, 242, 244, 246, 248, 250, 252, 254, 256, 258, 260, 262, 264, 266, 268, 270, 272, 274, 276, 278, 280, 282, 284, 286, 288, 290, 292, 294, 296, 298, 300, 302, 304, 306, 308, 310, 312, 314, 316, 318, 320, 322, 324, 326, 328, 330, 332, 334, 336, 338, 340, 342, 344, 346, 348, 350, 352, 354, 356, 358, 360, 362, 364, 366, 368, 370, 372, 374, 376, 378, 380, 382, 384, 386, 388, 390, 392, 394, 396, 398, 400, 402, 404, 406, 408, 410, 412, 414, 416, 418, 420, 422, 424, 426, 428, 430, 432, 434, 436, 438, 440, 442, 444, 446, 448, 450, 452, 454, 456, 458, 460, 462, 464, 466, 468, 470, 472, 474, 476, 478, 480, 482, 484, 486, 488, 490, 492, 494, 496, 498, 500, 502, 504, 506, 508, 510, 512, 514, 516, 518, 520, 522, 524, 526, 528, 530, 532, 534, 536, 538, 540, 542, 544, 546, 548, 550, 552, 554, 556, 558, 560, 562, 564, 566, 568, 570, 572, 574, 576, 578, 580, 582, 584, 586, 588, 590, 592, 594, 596, 598, 600, 602, 604, 606, 608, 610, 612, 614, 616, 618, 620, 622, 624, 626, 628, 630, 632, 634, 636, 638, 640, 642, 644, 646, 648, 650, 652, 654, 656, 658, 660, 662, 664, 666, 668, 670, 672, 674, 676, 678, 680, 682, 684, 686, 688, 690, 692, 694, 696, 698, 700, 702, 704, 706, 708, 710, 712, 714, 716, 718, 720, 722, 724, 726, 728, 730, 732, 734, 736, 738, 740, 742, 744, 746, 748, 750, 752, 754, 756, 758, 760, 762, 764, 766, 768, 770, 772, 774, 776, 778, 780, 782, 784, 786, 788, 790, 792, 794, 796, 798, 800, 802, 804, 806, 808, 810, 812, 814, 816, 818, 820, 822, 824, 826, 828, 830, 832, 834, 836, 838, 840, 842, 844, 846, 848, 850, 852, 854, 856, 858, 860, 862, 864, 866, 868, 870, 872, 874, 876, 878, 880, 882, 884, 886, 888, 890, 892, 894, 896, 898, 900, 902, 904, 906, 908, 910, 912, 914, 916, 918, 920, 922, 924, 926, 928, 930, 932, 934, 936, 938, 940, 942, 944, 946, 948, 950, 952, 954, 956, 958, 960, 962, 964, 966, 968, 970, 972, 974, 976, 978, 980, 982, 984, 986, 988, 990, 992, 994, 996, 998, 1000

**TIBBATTS ABEL**  
Fire Safety Engineers  
100, 102, 104, 106, 108, 110, 112, 114, 116, 118, 120, 122, 124, 126, 128, 130, 132, 134, 136, 138, 140, 142, 144, 146, 148, 150, 152, 154, 156, 158, 160, 162, 164, 166, 168, 170, 172, 174, 176, 178, 180, 182, 184, 186, 188, 190, 192, 194, 196, 198, 200, 202, 204, 206, 208, 210, 212, 214, 216, 218, 220, 222, 224, 226, 228, 230, 232, 234, 236, 238, 240, 242, 244, 246, 248, 250, 252, 254, 256, 258, 260, 262, 264, 266, 268, 270, 272, 274, 276, 278, 280, 282, 284, 286, 288, 290, 292, 294, 296, 298, 300, 302, 304, 306, 308, 310, 312, 314, 316, 318, 320, 322, 324, 326, 328, 330, 332, 334, 336, 338, 340, 342, 344, 346, 348, 350, 352, 354, 356, 358, 360, 362, 364, 366, 368, 370, 372, 374, 376, 378, 380, 382, 384, 386, 388, 390, 392, 394, 396, 398, 400, 402, 404, 406, 408, 410, 412, 414, 416, 418, 420, 422, 424, 426, 428, 430, 432, 434, 436, 438, 440, 442, 444, 446, 448, 450, 452, 454, 456, 458, 460, 462, 464, 466, 468, 470, 472, 474, 476, 478, 480, 482, 484, 486, 488, 490, 492, 494, 496, 498, 500, 502, 504, 506, 508, 510, 512, 514, 516, 518, 520, 522, 524, 526, 528, 530, 532, 534, 536, 538, 540, 542, 544, 546, 548, 550, 552, 554, 556, 558, 560, 562, 564, 566, 568, 570, 572, 574, 576, 578, 580, 582, 584, 586, 588, 590, 592, 594, 596, 598, 600, 602, 604, 606, 608, 610, 612, 614, 616, 618, 620, 622, 624, 626, 628, 630, 632, 634, 636, 638, 640, 642, 644, 646, 648, 650, 652, 654, 656, 658, 660, 662, 664, 666, 668, 670, 672, 674, 676, 678, 680, 682, 684, 686, 688, 690, 692, 694, 696, 698, 700, 702, 704, 706, 708, 710, 712, 714, 716, 718, 720, 722, 724, 726, 728, 730, 732, 734, 736, 738, 740, 742, 744, 746, 748, 750, 752, 754, 756, 758, 760, 762, 764, 766, 768, 770, 772, 774, 776, 778, 780, 782, 784, 786, 788, 790, 792, 794, 796, 798, 800, 802, 804, 806, 808, 810, 812, 814, 816, 818, 820, 822, 824, 826, 828, 830, 832, 834, 836, 838, 840, 842, 844, 846, 848, 850, 852, 854, 856, 858, 860, 862, 864, 866, 868, 870, 872, 874, 876, 878, 880, 882, 884, 886, 888, 890, 892, 894, 896, 898, 900, 902, 904, 906, 908, 910, 912, 914, 916, 918, 920, 922, 924, 926, 928, 930, 932, 934, 936, 938, 940, 942, 944, 946, 948, 950, 952, 954, 956, 958, 960, 962, 964, 966, 968, 970, 972, 974, 976, 978, 980, 982, 984, 986, 988, 990, 992, 994, 996, 998, 1000



# Current plans

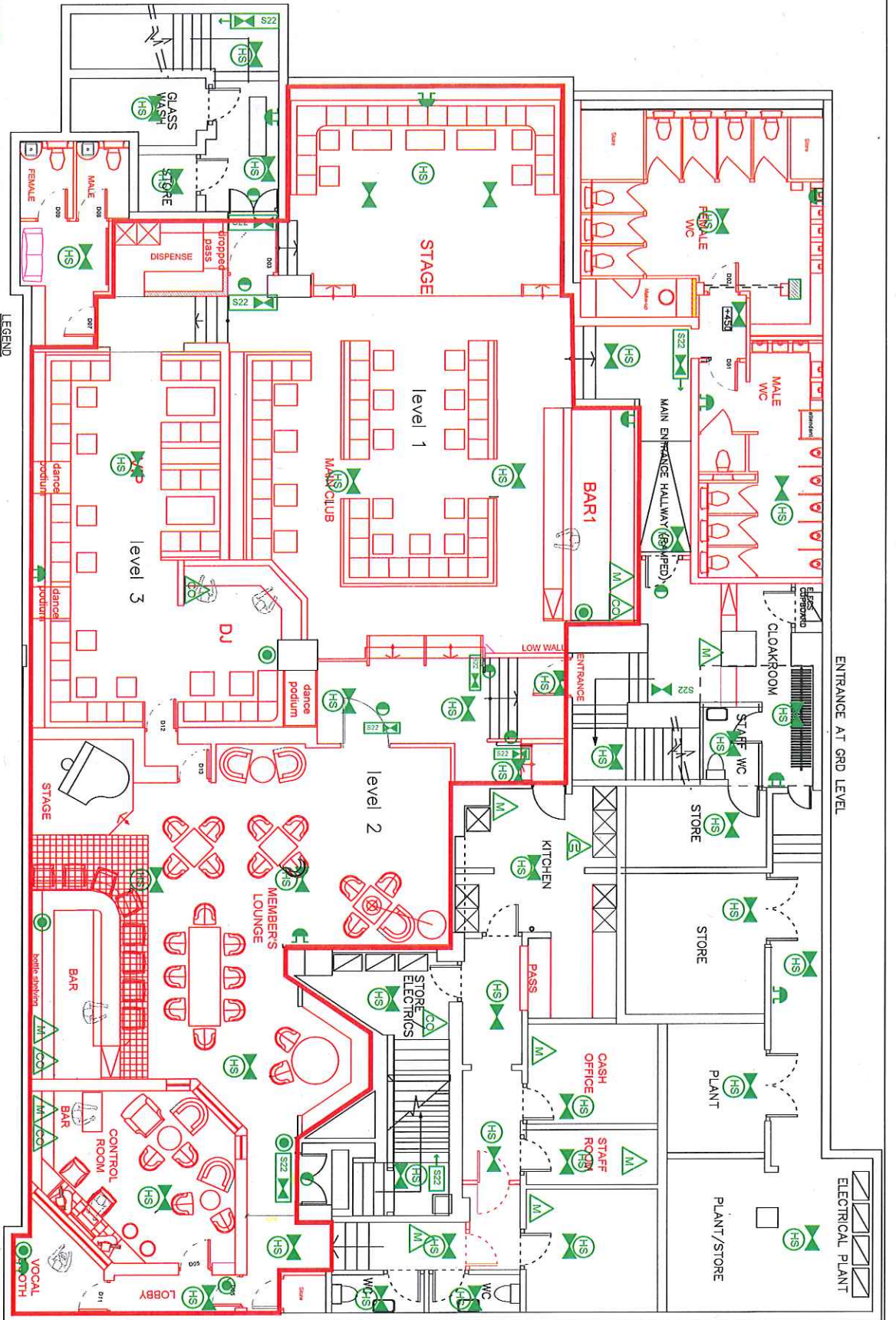

AREA WHERE LICENSABLE ACTIVITIES WILL TAKE PLACE

NOTE  
CONSUMPTION OF ALCOHOL AND LICENSABLE ACTIVITIES TAKE PLACE ANYWHERE WITHIN THE PREMISES.  
THE POSITION OF ANY LOOSE FURNITURE IS SHOWN FOR DIAGNOSTIC PURPOSES ONLY.  
THE LOCATION OF FIRE EQUIPMENT IS SHOWN ON THE DATE HEREOF BUT MAY BE MOVED WITH THE CONSENT OF THE FIRE OFFICER.

### LEGEND

- FIRE SIGNAGE**  
(EXACT LOCATION TO BE AGREED ON SITE)
- S22 ILLUMINATED FIRE EXIT SIGN
  - S22 ILLUMINATED FIRE EXIT SIGN (DIRECTIONAL)
  - S22 ILLUMINATED FIRE EXIT SIGN (DIRECTIONAL)
  - S14 FIRE DOOR KEPT LOCKED
  - S13 FIRE DOOR KEPT CLOSED
  - S14-FSD FIRE DOOR KEPT LOCKED
  - S20 FIRE ESCAPE KEEP CLEAR
- DOOR TYPE KEY**
- DS FD30S
  - S FD60S
  - S FD30
  - FD60
  - PB STANDALONE NON-RATED DOOR
- FIRE SAFETY EQUIPMENT**  
(EXACT LOCATION TO BE AGREED ON SITE)
- DP FIRE EXTINGUISHER - DRY POWDER
  - CD FIRE EXTINGUISHER - CARBON DIOXIDE
  - W FIRE EXTINGUISHER - WATER
  - M FIRE EXTINGUISHER - MULTI PURPOSE
  - E FIRE BLANKET
  - DS AUTOMATIC SMOKE DETECTOR
  - DH AUTOMATIC HEAT DETECTOR
  - HS COMBINED AUTOMATIC HEAT/SMOKE DETECTOR
  - HA FIRE ALARM CALL POINT
  - AW AUDIBLE WARNING DEVICE
- AREA COVERED WITH A SYSTEM OF ESCAPE LIGHTING THAT WILL ILLUMINATE THE AREA UPON FAILURE OF THE NORMAL LIGHTING POWER SUPPLY TO A SUFFICIENT STANDARD TO ENABLE PERSONS TO LEAVE THE AREA SAFELY. THE ESCAPE LIGHTING SYSTEM SHOULD CONFORM TO THE BRITISH STANDARD CURRENT AT THE TIME OF ITS INSTALLATION AND A CERTIFICATE TO THIS EFFECT KEPT WITH THE FIRE CERTIFICATE.**

**TIBBATT'S-ABEL**  
Fireworks - Amusement  
Licence No. 1520/AT  
17 Hanover Square  
Mayfair

**Movement Bars Ltd**  
17 Hanover Square  
Mayfair

**Licensing Plan**

1602-003

Applicant Supporting Documents

Appendix 2

None submitted

## Appendix 3

## Licence History

<b>Application</b>	<b>Details of Application</b>	<b>Date Determined</b>	<b>Decision</b>
05/02570/LIPCV	Conversion and variation of the Justices' on licence, public entertainment licence and special hours certificate	01.06.2005	Granted by Licensing Sub-Committee
05/12636/LIPT	Application to transfer the licence from SFI Group Ltd to The Laurel Pub Company Ltd	13.01.2006	Granted under delegated authority
05/12218/LIPDPS	Application to vary the Designated Premises Supervisor	23.01.2006	Granted under delegated authority
06/02898/LIPV	Application to vary the plans	26.05.2006	Granted under delegated authority
06/07360/LIPDPS	Application to vary the Designated Premises Supervisor	26.05.2006	Granted under delegated authority
08/00685/LIPT	Application to transfer the licence to Hanover Bars Limited	19.02.2008	Granted under delegated authority
08/00698/LIPDPS	Application to vary the Designated Premises Supervisor	19.02.2008	Granted under delegated authority
08/01146/LIPV	Application to vary the plans	03.09.2008	Granted under delegated authority
08/08921/LIPDPS	Application to vary the Designated Premises Supervisor	22.11.2008	Granted under delegated authority
11/02962/LIPDPS	Application to vary	19.04.2011	Granted under

	the Designated Premises Supervisor		delegated authority
11/08544/LIPVM	Minor variation to amend the plans	19.09.2011	Granted under delegated authority
13/08112/LIPVM	Minor variation to add conditions requested by the Metropolitan Police to the licence	07.11.2011	Granted under delegated authority
13/09071/LIPDPS	Application to vary the Designated Premises Supervisor	19.11.2013	Granted under delegated authority
13/10276/LIDPSR	Request to remove the Designated Premises Supervisor	24.01.2014	Granted under delegated authority
14/03741/LIPDPS	Application to vary the Designated Premises Supervisor	12.05.2014	Granted under delegated authority
14/05081/LIPVM	Minor variation to amend the plans and remove conditions	08.07.2015	Granted under delegated authority
15/00015/LIPVM	Minor variation to amend the plans	23.01.2015	Granted under delegated authority
15/01379/LIPDPS	Application to vary the Designated Premises Supervisor	13.04.2015	Granted under delegated authority
15/03270/LIPV	Application to vary the plans	08.09.2015	Granted under delegated authority
15/06783/LIPVM	Minor variation to amend the plans	18.09.2015	Granted under delegated authority
15/09203/LIPDPS	Application to vary the Designated Premises Supervisor	23.10.2015	Granted under delegated authority

*CONDITIONS CONSISTENT WITH THE OPERATING SCHEDULE AND CONDITIONS PROPOSED BY A PARTY TO THE HEARING*

When determining an application for variation of a premises licence under the provisions of the Licensing Act 2003, the licensing authority must, unless it decides to reject the application, grant the licence subject to the conditions which are indicated as mandatory in this schedule.

At a hearing the licensing authority may, in addition, and having regard to any representations received, grant the licence subject to such conditions which are consistent with the operating schedule submitted by the applicant as part of their application, or alter or omit these conditions, or add any new condition to such extent as the licensing authority considers appropriate for the promotion of the licensing objectives.

This schedule lists those conditions which are consistent with the operating schedule, or proposed as appropriate for the promotion of the licensing objectives by a responsible authority or an interested party as indicated. These conditions have not been submitted by the licensing service but reflect the positions of the applicant, responsible authority or interested party and have not necessarily been agreed

**Conditions: On Current Licence -**

**Mandatory:**

1. No supply of alcohol may be made at a time when there is no designated premises supervisor in respect of this licence.
2. No supply of alcohol may be made at a time when the designated premises supervisor does not hold a personal licence or the personal licence is suspended.
3. Every supply of alcohol under this licence must be made or authorised by a person who holds a personal licence.
4.
  - (1) The responsible person must ensure that staff on relevant premises do not carry out, arrange or participate in any irresponsible promotions in relation to the premises.
  - (2) In this paragraph, an irresponsible promotion means any one or more of the following activities, or substantially similar activities, carried on for the purpose of encouraging the sale or supply of alcohol for consumption on the premises—
    - (a) games or other activities which require or encourage, or are designed to require or encourage, individuals to;
      - (i) drink a quantity of alcohol within a time limit (other than to drink alcohol sold or supplied on the premises before the cessation of the period in which the responsible person is authorised to sell or supply alcohol), or

- (ii) drink as much alcohol as possible (whether within a time limit or otherwise);
  - (b) provision of unlimited or unspecified quantities of alcohol free or for a fixed or discounted fee to the public or to a group defined by a particular characteristic in a manner which carries a significant risk of undermining a licensing objective;
  - (c) provision of free or discounted alcohol or any other thing as a prize to encourage or reward the purchase and consumption of alcohol over a period of 24 hours or less in a manner which carries a significant risk of undermining a licensing objective;
  - (d) selling or supplying alcohol in association with promotional posters or flyers on, or in the vicinity of, the premises which can reasonably be considered to condone, encourage or glamorise anti-social behaviour or to refer to the effects of drunkenness in any favourable manner;
  - (e) dispensing alcohol directly by one person into the mouth of another (other than where that other person is unable to drink without assistance by reason of a disability).
5. The responsible person must ensure that free potable water is provided on request to customers where it is reasonably available.
6. (1) The premises licence holder or club premises certificate holder must ensure that an age verification policy is adopted in respect of the premises in relation to the sale or supply of alcohol.
- (2) The designated premises supervisor in relation to the premises licence must ensure that the supply of alcohol at the premises is carried on in accordance with the age verification policy.
- (3) The policy must require individuals who appear to the responsible person to be under 18 years of age (or such older age as may be specified in the policy) to produce on request, before being served alcohol, identification bearing their photograph, date of birth and either—
- (a) a holographic mark, or
  - (b) an ultraviolet feature.
7. The responsible person must ensure that—
- (a) where any of the following alcoholic drinks is sold or supplied for consumption on the premises (other than alcoholic drinks sold or supplied having been made up in advance ready for sale or supply in a securely closed container) it is available to customers in the following measures—
    - (i) beer or cider: ½ pint;
    - (ii) gin, rum, vodka or whisky: 25 ml or 35 ml; and

- (iii) still wine in a glass: 125 ml;
- (b) these measures are displayed in a menu, price list or other printed material which is available to customers on the premises; and
- (c) where a customer does not in relation to a sale of alcohol specify the quantity of alcohol to be sold, the customer is made aware that these measures are available.

A responsible person in relation to a licensed premises means the holder of the premises licence in respect of the premises, the designated premises supervisor (if any) or any individual aged 18 or over who is authorised by either the licence holder or designated premises supervisor. For premises with a club premises certificate, any member or officer of the club present on the premises in a capacity that which enables him to prevent the supply of alcohol.

8(i) A relevant person shall ensure that no alcohol is sold or supplied for consumption on or off the premises for a price which is less than the permitted price.

8(ii) For the purposes of the condition set out in paragraph 8(i) above -

- (a) "duty" is to be construed in accordance with the Alcoholic Liquor Duties Act 1979;
- (b) "permitted price" is the price found by applying the formula -

$$P = D + (D \times V)$$

Where -

- (i) P is the permitted price,
  - (ii) D is the amount of duty chargeable in relation to the alcohol as if the duty were charged on the date of the sale or supply of the alcohol, and
  - (iii) V is the rate of value added tax chargeable in relation to the alcohol as if the value added tax were charged on the date of the sale or supply of the alcohol;
- (c) "relevant person" means, in relation to premises in respect of which there is in force a premises licence -
- (i) the holder of the premises licence,
  - (ii) the designated premises supervisor (if any) in respect of such a licence, or
  - (iii) the personal licence holder who makes or authorises a supply of alcohol under such a licence;
- (d) "relevant person" means, in relation to premises in respect of which there is in force a club premises certificate, any member or officer of the club present on the premises in a capacity which enables the member or officer to prevent the supply in question; and

- (e) "value added tax" means value added tax charged in accordance with the Value Added Tax Act 1994.
- 8(iii). Where the permitted price given by Paragraph 8(ii)(b) above would (apart from this paragraph) not be a whole number of pennies, the price given by that sub-paragraph shall be taken to be the price actually given by that sub-paragraph rounded up to the nearest penny.
- 8(iv). (1) Sub-paragraph 8(iv)(2) below applies where the permitted price given by Paragraph 8(ii)(b) above on a day ("the first day") would be different from the permitted price on the next day ("the second day") as a result of a change to the rate of duty or value added tax.
- (2) The permitted price which would apply on the first day applies to sales or supplies of alcohol which take place before the expiry of the period of 14 days beginning on the second day.
9. Admission of children to the premises must be restricted in accordance with the film classification recommended by the British Board of Film Classification or recommended by this licensing authority as appropriate.
10. All persons guarding premises against unauthorised access or occupation or against outbreaks of disorder or against damage (door supervisors) must be licensed by the Security Industry Authority.

**Conditions reproducing the effect of conditions subject to which the relevant existing licences have effect**

11. On New Year's Eve the premises can remain open for the purpose of providing regulated entertainment from the time when the provision of regulated entertainment must otherwise cease on New Year's Eve to the time when regulated entertainment can commence on New Year's Day (or until midnight on New Year's Eve where no regulated entertainment takes place on New Year's Day).

**Conditions which reproduce the effect of any restriction imposed on these of the premises by specified enactments**

12. The Sale by Retail of Alcohol is permitted On New Year's Eve from the end of permitted hours on New Year's Eve to the start of permitted hours on the following day (or, if there are no permitted hours on the following day, 00.00 midnight on 31st December).
13. The terminal hour for late night refreshment on New Year's Eve is extended to 05:00 on New Year's Day.



## **Annex 2 – Conditions consistent with the operating Schedule**

14. The number of persons accommodated at any one time (excluding staff) shall not exceed 400 persons.

### **Condition proposed by Environmental Health and accepted by the applicant**

- 14a. *The number of persons accommodated at any one time (excluding staff) shall not exceed:*
  - Tape – 300 persons*
  - Little Tape 100 persons*
15. A noise limiter located in a separate and remote lockable cabinet from the volume control must be fitted to the musical amplification system set at a level determined by and to the satisfaction of an authorised officer of the Environmental Health Service's Community Protection Department so as to ensure that no public nuisance is caused to local residents or businesses. The operational panel of the noise limiter shall then be secured to the satisfaction of officers from the Environmental Health Service. The keys securing the noise limiter cabinet shall be held by the applicant only, and shall not be accessed by any other person. The limiter shall not be altered without prior agreement with the Environmental Health Service. No alteration or modification to any existing sound system(s) should be effected without prior knowledge of an authorised Officer of the Environmental Health Service.
16. Notices shall be prominently displayed at the exit requesting patrons to respect the needs of local residents and to leave the premises and the area quietly.
17. No noise shall emanate from the premises nor vibration be transmitted through the structure of the premises which gives rise to a nuisance.
18. No consumption of alcoholic or other drinks shall be permitted outside the premises.
19. The pavement from the building line to the kerb edge immediately outside the premises, including gutter/channel at its junction with the kerb edge, is swept and or washed, and litter and sweepings collected and stored in accordance with the approved refuse storage arrangements.
20. The premises have installed and will maintain a comprehensive CCTV system agreed with the Westminster Police Licensing Team. All entry and exit points will be covered enabling frontal identification of every person entering. The CCTV system shall continually record whilst the premises is open for licensable activities and during all times when customers remain on the premises. All recordings shall be stored for a minimum period of 31 days with date and time stamping. Viewing of recordings shall be made available immediately upon reasonable request of Police or authorised officer.
21. A staff member who is conversant with the operation of the CCTV system shall be on the premises at all times when the premises is open. This staff member must be able to provide a Police or authorised council officer copies of recent CCTV images or data with the absolute minimum of delay when requested.

22. An incident log shall be kept at the premises, and made available on request to an authorised officer of the City Council or the Police, which will record the following:
- (a) all crimes reported to the venue
  - (b) all ejections of patrons
  - (c) any complaints received concerning crime and disorder
  - (d) any incidents of disorder
  - (e) all seizures of drugs or offensive weapons
  - (f) any faults in the CCTV system or searching equipment or scanning equipment
  - (g) any refusal of the sale of alcohol
  - (h) any visit by a relevant authority or emergency service.
23. Save for drinks served to customers seated at tables on the pavement in an area with the benefit of the appropriate permission to place tables and chairs on the highway, no drinks shall be consumed outside the premises nor glasses/bottles removed from the premises by patrons when leaving.

### **Annex 3 – Conditions attached after a hearing by the licensing authority**

24. Persons who look under 18 will be asked for ID before they will be admitted to the premises at certain times or on certain occasions, or sold alcohol. Staff will be trained and their training will include this aspect and the need for vigilance.
25. The only ID that is accepted will be that approved by PASS, photo driving licences or passports.
26. If necessary, notices will be displayed warning customers of prevalent criminal offences.
27. There will be no irresponsible drinks promotions (e.g. all you can drink for £10).
28. When disabled people are present, adequate arrangements to enable their safe evacuation in the event of an emergency must exist.
29. Evacuation procedures must be made known to those using the premises.
30. The Fire Brigade must be called to any outbreak of fire and the details recorded.
31. The Fire Brigade must be notified as soon as possible after the operator becomes aware if the water supply to any hydrant, hose reel, sprinkler or other fire extinguishing installation is cut off or restricted.
32. Insofar as it is within the ability of the operator to do so, access for emergency vehicles will be kept clear.
33. Staff with specific responsibilities in the event of fire or other emergency, together with deputies, shall receive training and written instruction appropriate to their role.

34. The approved arrangements at the premises, including means of escape provisions, fire warning and fire fighting equipment, the electrical installation and mechanical equipment, shall at all material times be maintained in good condition and full working order.
35. The means of escape provided for the premises shall be maintained unobstructed, free of trip hazards, be immediately available and clearly identified in accordance with the plans provided.
36. Escape routes will be kept clear and unobstructed, in good order with non-slippery and even surfaces, free of trip hazards and clearly identified.
37. All exit doors shall be available at all material times without the use of a key, code, card or similar means.
38. Doors at such exits will be regularly checked to ensure that they function satisfactorily, and a record of the check kept.
39. Any removable security fastenings will be removed whenever the premises are open to the public.
40. All fire doors will be maintained effectively self-closing, and not held open other than by an approved device.
41. Fire resisting doors to ducts, service shafts and cupboards shall be kept locked shut.
42. The edges of the treads of steps and stairways shall be maintained so as to be conspicuous.
43. Safety checks will be carried out prior to the admission of the public and details of such checks maintained on site.
44. The recommended practices in the Health and Safety Risk Assessment with regards to the safety checks and the provision of first aid will be followed.
45. Only hangings, curtains, upholstery and temporary decorations, complying with the relevant British (or where appropriate European) Standard shall be used. Where necessary these shall be periodically tested for flame resistance and re-treated as necessary.
46. Curtains and hangings shall be arranged so as not to obstruct fire safety signs, fire extinguishers or other fire fighting equipment.
47. Emergency lighting shall not be altered (unless the Fire Brigade consent) and batteries will be fully charged before the public are admitted.
48. Fire safety signs will be adequately illuminated.
49. In the event of normal lighting falling, and the escape lighting has a 1 hr capacity, the public shall leave the premises within 30 minutes or within 60 minutes if the

capacity is 3 hours and not be readmitted (unless normal lighting has been restored and the battery is re-charged).

50. The flue of any boiler or heating appliance shall be professionally cleaned at intervals not less than the minimum recommended by the appliance manufacturer.
51. Ventilation ducting and shafts shall generally be maintained in a clean condition.
52. Ventilation air filters shall be cleaned or changed for new filters periodically as may be necessary to maintain a satisfactory flow of air supply.
53. All interior surfaces of extract ventilation ducting serving kitchens and serveries shall be thoroughly cleansed at least annually.
54. Grease filters in extract ventilation hoods in kitchens and serveries shall be regularly cleaned e.g. weekly.
55. Arrangements will be made to ensure that any capacity limit set for the premises can be properly monitored. Information regarding the capacity should be given to an authorised officer on request.
56. No temporary electrical installations will be used unless their compliance with BS requirements has previously been confirmed by a competent person.
57. No changes shall be made to the approved layout of the premises without the consent of the Council.
58. Any special effects or mechanical installations shall be arranged and stored so as to minimise any risk to the safety of those using the premises. The following special effects will only be used on 7 days prior notice being given to the Council where consent has not previously been given.
  - a. dry ice and cryogenic fog
  - b. smoke machines and fog generators
  - c. pyrotechnics including fire works
  - d. firearms
  - e. lasers
  - f. explosives and highly flammable substances
  - g. real flame
  - h. strobe lighting
59. No person shall give at the premises any exhibition, demonstration or performance of hypnotism, mesmerism or any other similar act or process which produces or is intended to produce in any other person any form of induced sleep or trance in which susceptibility of the mind of that person to suggestion or direction is increased or intended to be increased. NOTE: (1) This rule does not apply to exhibitions given under the provisions of Section 2(1A) and 5 of the Hypnotism Act 1952.
60. The certificates listed below shall be submitted to the Council annually.

- a. Any emergency lighting battery or system
  - b. Any electrical installation
  - c. Any fire alarm system
61. Noise and vibration will not be allowed to emanate from the premises so as to cause a nuisance to nearby properties.
  62. Notices will be prominently displayed at exits requesting the public to respect the needs of local residents and to leave the premises and the area quietly.
  63. No rubbish including bottles will be moved, removed or placed in outside areas between 23:00 hours and 08:00 hours.
  64. All entrance and exit doors shall remain closed after 21:00 except for the immediate access and egress of patrons.
  65. Flashing or particularly bright lights on or outside the premises will not be permitted to cause a nuisance to nearby properties (save insofar as they are necessary for the prevention of crime).
  66. Substantial food will be available at all times during the hours of operations.
  67. All sales of alcohol for consumption off the premises shall be in sealed containers only and shall not be permitted after 23:00 hours.
  68. All persons under 18 will not be allowed to remain on the premises after 19:00 hours or when Happy Hours or similar promotions are in operation.
  69. In the event of a video show or similar, any British Board of Film Classification or Council age limit will be adhered to, and notices to this effect will be displayed advising of the age limit in question.
  70. No notices or posters shall be displayed at the premises that advertise adult entertainment when persons under 18 are on the premises.

Tape 17 Hanover Square

Appendix 5

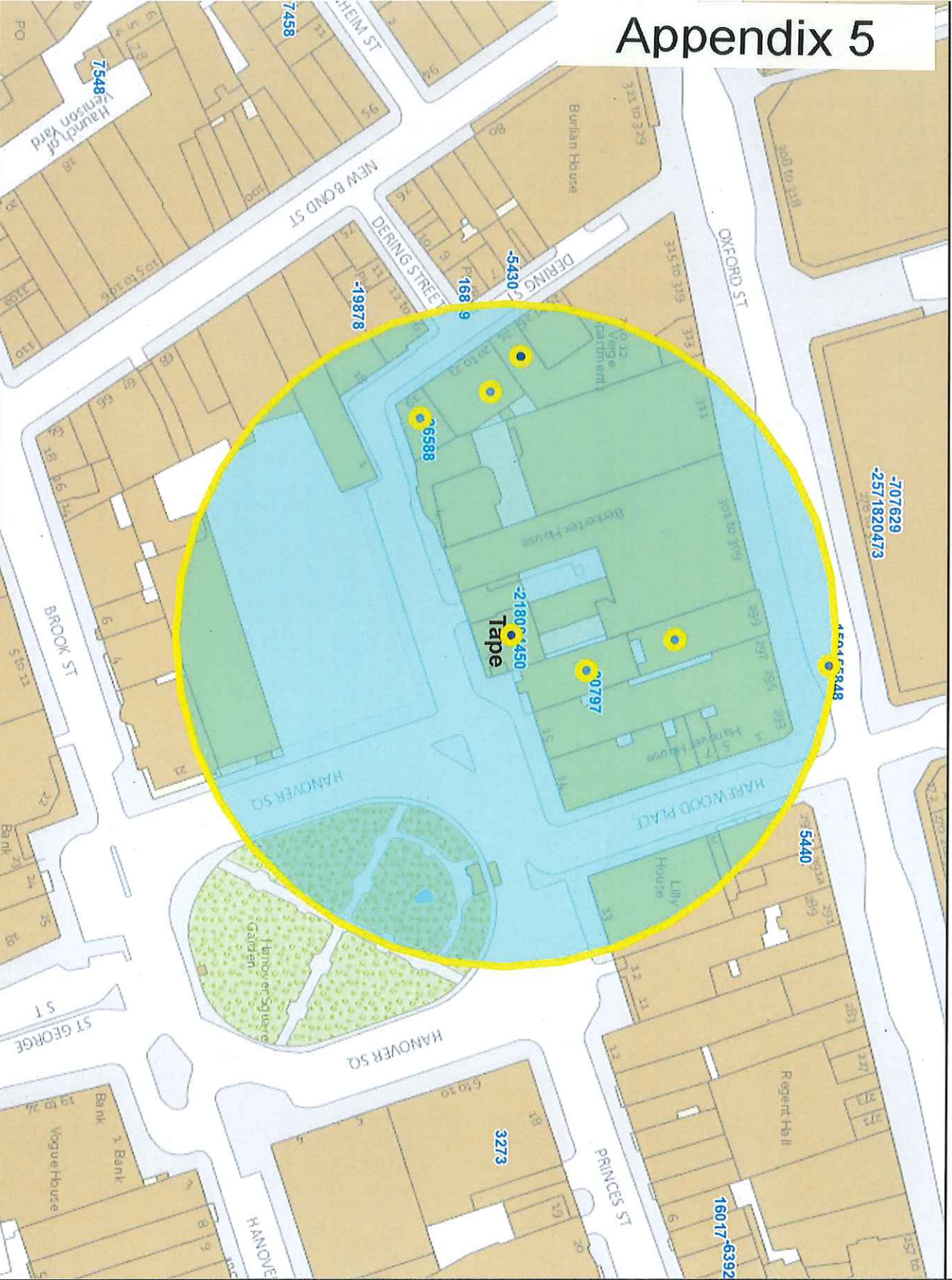

10  
Meters

This product includes mapping data licensed from Ordnance Survey with the permission of the Controller of Her Majesty's Stationery Office. © Crown copyright and/or database right 2013. All rights reserved. Licence number: LA 100010507

Residential / Proposed Residential	13
Under Construction	Not Stated
Other Uses	Not Stated
Proportion Residential of all Uses	Not Stated
Data Source: Uniform Database	
Date: 07/09/2016	

**Premises within 75 metres of: Tape Basement 17 Hanover Square**

<b>p / n</b>	<b>Name of Premises</b>	<b>Premises Address</b>	<b>Licensed Hours</b>
30797	Not Recorded	16 Hanover Square London W1S 1HS	Monday to Friday 18:30 - 22:30
-21800	Tape	Basement 17 Hanover Square London W1S 1HU	Sunday 09:00 - 02:30 Monday to Saturday 09:00 - 03:30
4450	Jalouse	Basement 17 Hanover Square London W1S 1HU	Sunday 09:00 - 02:30 Monday to Saturday 09:00 - 03:30
5848	Oxford Street Area	Oxford Street London	Monday to Sunday 00:00 - 00:00
15915	West End Area	Oxford Street London	Monday to Sunday 00:00 - 00:00
26588	The Loop	19 Dering Street London W1S 1AJ	Monday to Saturday 09:00 - 03:30 Sunday 12:00 - 23:00